

Oil Supply & Air bleeding

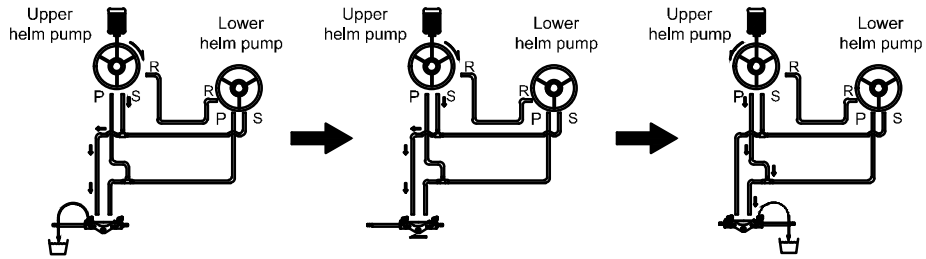

Step 1)
After moving the cylinder as shown in the figure, loosen the Port Air bleeder of the cylinder and turn the steering wheel to the Starboard from the upper helm pump to bleed air.

Step 2)
After completing the air bleeding, lock the Air bleeder and move the cylinder by turning the steering wheel to the Starboard.

Step 3)
Loosen the Starboard Air bleeder and turn the steering wheel to the port to bleed air.

During the oil filing, turn the steering wheel slowly.

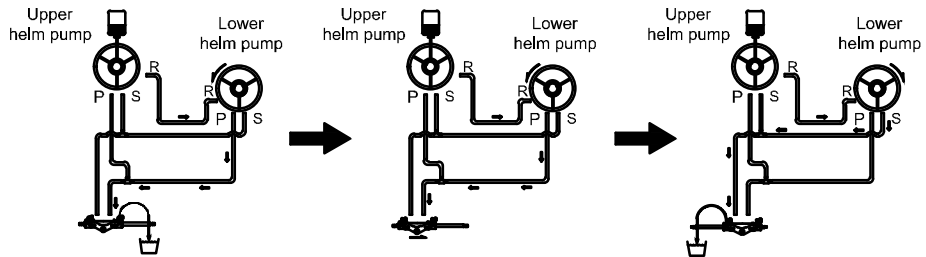

Step 4)
Turn the steering wheel to port from the lower helm pump to bleed air.

Step 5)
After completing the air Bleeding, lock the air bleeder and Move the cylinder by turning The steering wheel to the port.

Step 6)
Loosen the Port Air Bleeder and turn the steering wheel To the starboard to bleed air.
After completing the air bleeding, Lock the air bleeder.

- Repeat the step 1) to 6) until normal wheel turn is obtained -

MANUAL

DUAL STATION KIT

MODEL

- Dual Station 1/4 : DHK-14 - TYPE
- Dual Station 3/8 : DHK-38 - TYPE



Supply Scope of Dual Station Kit

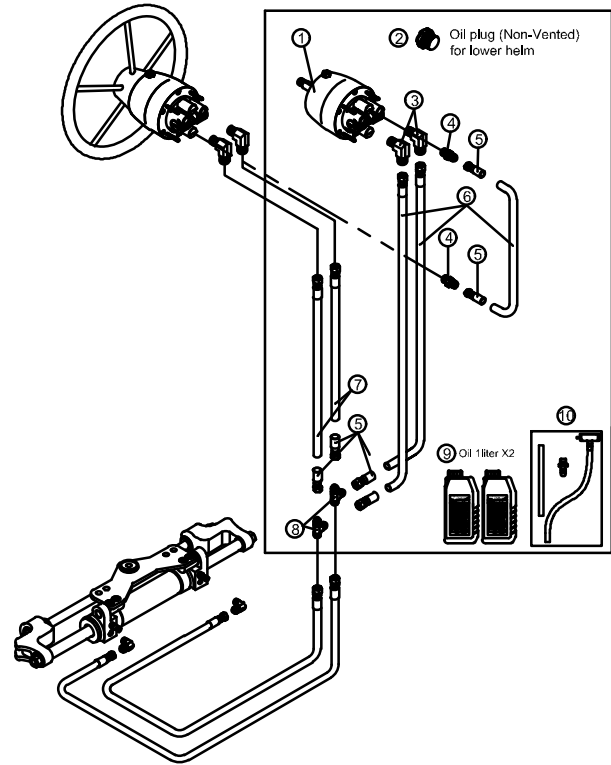

No	Description	Dual Station 1/4 DHK-14-TYPE	Dual Station 3/8 DHK-38-Type	Q'TY
1	Helm Pump	Choose helm model	Choose helm model	1
2	Oil plug(Non-vented)	C1800803	C1800803	1
3	Elbow Fitting(O-ring)	HLO14H0S	HLO14N0S	2
4	Straight Fitting(O-ring)	HSO14HS	HSO14NS	2
5	Campuka / Reusable	CPK0414	C3520149	6
6	Hose - 30M	NH04-SS-30	NH06-SS-30	1
7	Hose - 04M	NH04-SS-04	NH06-SS-04	1
8	T - Fitting	HTH300	HTN300	2
9	OIL (1LITER)	SF-OIL-15	SF-OIL-15	2
10	OIL Accessories Kit	OAK-300	OAK-300	2

Precaution for oil supply

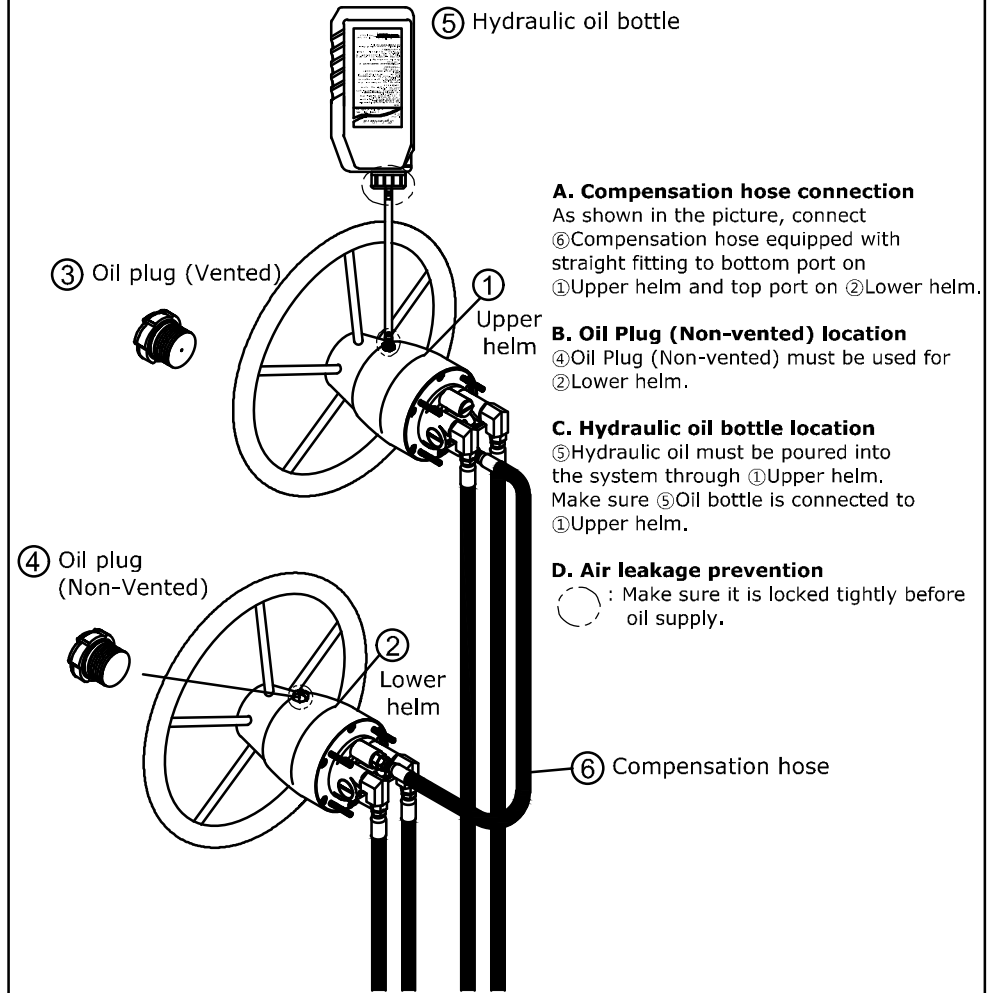

- ① : Upper Helm
- ② : Lower Helm
- ③ : Oil Plug (Vented)
- ④ : Oil Plug (Non-vented, included in dual station kit)
- ⑤ : Hydraulic oil bottle
- ⑥ : Compensation hose