



**Nuova Rade**

Marine - Plastics Technology Experts

## Instructions for flexible water tanks

1. Rinse tank thoroughly with fresh water.
2. Attach the inlet and outlet at desired positions on the already welded tank fittings' adapter.
3. Tighten the elbow fitting with the provided moveable tightening ring nut **DO NOT OVERTIGHT.**
4. When the tank is not used, please fill the tank with water and sodium bicarbonate in order to remove the remnants of algae. Rinse with fresh water and store the water tank in a dry place. Repeat this procedure, if needed, at the beginning of each new season.

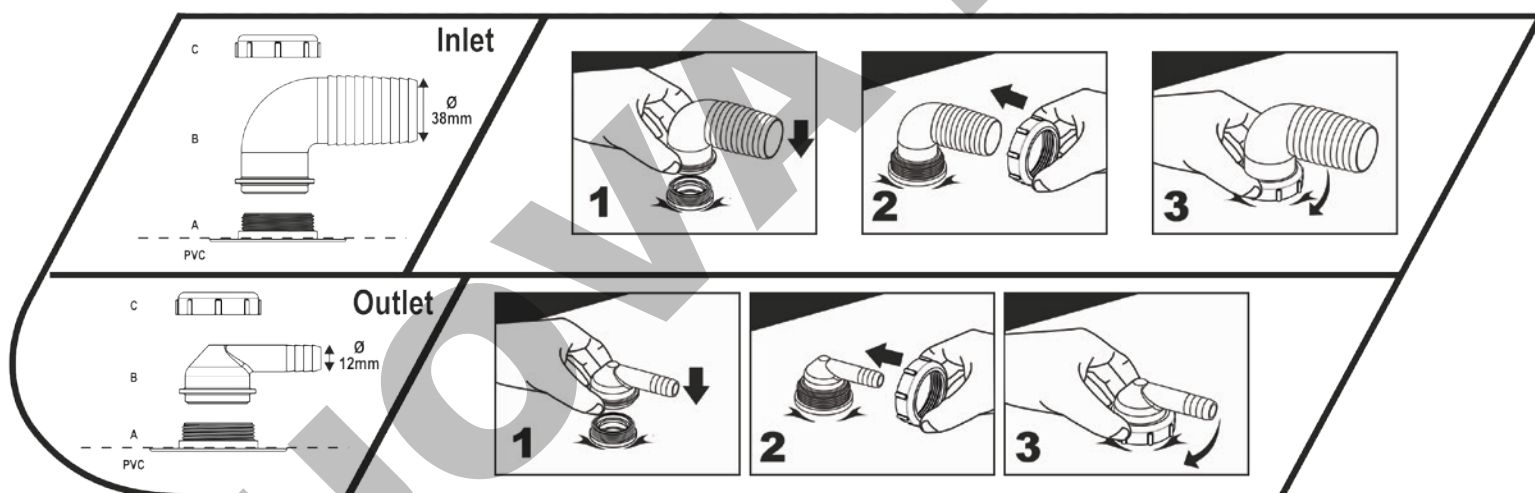

**DO NOT OVERFILL**